

MiniTi™

SUTURE ANCHOR

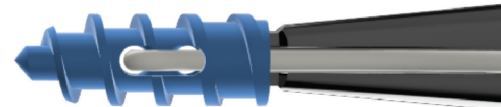

The MiniTi™ is engineered for optimal small-joint ligament repair

FEATURES AND BENEFITS

Titanium Anchor Body:

- Optimal cortical function
- Engineered for ultimate mechanical properties (pull-out strength, tensile strength et.)

Anchor Size:

- Small diameter allows for precise anchor management
- Post-less design to avoid tissue irritation and enables cortical fixation
- Unique post-less design allows for a more shallow hole depth when limited bone is available

MATERIALS & SPECIFICATIONS

Anchor Material: Certified ISO 5832-3 Medical Grade Titanium (TI 6Al 4V)

Anchor size: 2mm x 6mm

Suture Material: UHMWPE braided sutures (non-absorbable)

Needles: Four BB-1 point needles

Introducer: Single-use introducer composing of medical grade stainless steel and silicone

EXTENSIVE APPLICATION RANGE

Small screw-in suture anchor used in a variety of small-joint applications

Intended for open wrist/hand and ankle/foot repair

Post-less design decreases amount of bone needed to fully insert the anchor



References

ATP003	MiniTi, Titanium Suture Anchor, 2 x 6mm, w/Needles & K-Wire Drill Tool
ATP003-I	MiniTi Introducer
ATP003-S	MiniTi, Titanium Suture Anchor, 2 x 6mm, w/Needles & K-Wire Drill Tool